

LUXURY *Yacht* GROUP

**FAST & FURIOUS**



# FAST & FURIOUS

**Length:** 44.60 metres (146' 4")

**Beam:** 8.30 metres (27' 3")

**Draft:** 1.3 metres (4' 3")

**Number of Guests:** 10

**Number of Crew:** 7

**Built:** 2016

**Builder:** AB Yachts

**Naval Architect:** AB Yachts

**Flag:** British Virgin Islands

**Hull Construction:** GRP

**Hull Configuration:** Planing hull

Air conditioning, Stabilisers at anchor, Stabilisers underway,  
WiFi connection on board

---

FAST & FURIOUS is an athletic superyacht and the largest in the AB YACHTS sporty range. Her striking and eye-catching exterior features characteristic portholes and smooth lines. Speed lovers will enjoy zipping between ports at a maximum speed of 42 knots with excellent stability. Her immaculate interior with patterned woods, neutral warm colours and high-end luxurious finishes makes her one of the most attractive yachts in the sporty category. The large flybridge and aft deck are ideal for al fresco dining and sunbathing.

# KEY FEATURES

- 1 Twice finalist at the World Superyacht Awards and ShowBoat Design Awards in 2016
- 2 12m Seawater Smeralda chase boat
- 3 Contemporary and bright living areas
- 4 Shallow draft for exclusive visits to secluded beaches and reefs
- 5 Fastest 40m+ available on the charter market reaching a max speed of 42 knots
- 6 Wide outdoor deck spaces for entertainment





Cruising



Aerial

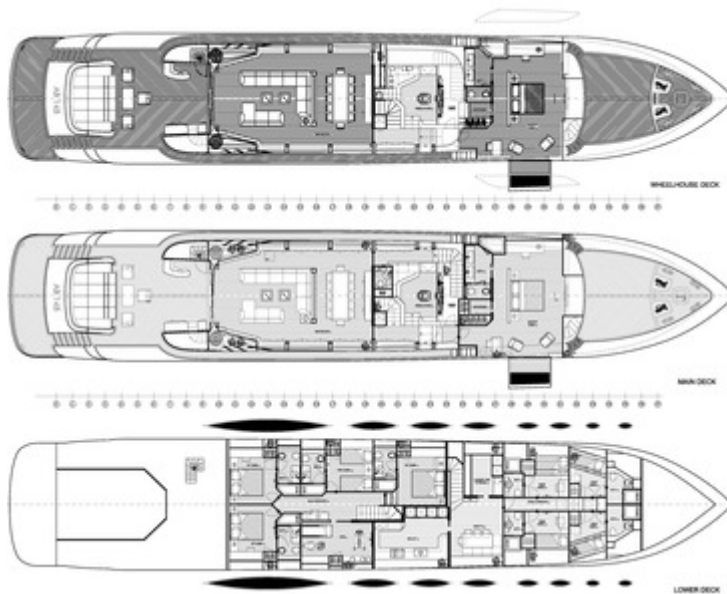

GA



Main Balcony





Master Bathroom



Cockpit lifestyle



Cockpit



Sun deck





VIP 1



Twin



Sun beds



Main Table salon





VIP 3



Gym, Yoga space



VIP Bathroom



VIP 2





Main Salon



Master



Master with view



Foredeck



# SPECIFICATIONS

## ACCOMMODATION

**Number of Guests:** 10

**Number of Cabins:** 5

**Cabin Configuration:** 4 Double, 1 Twin

**Bed Configuration:** 1 King, 3 Queen, 2 Single

## EQUIPMENT

**Engines:** Engines:

3 x 2,600hp MTU 16V2000 M94

**Generators:**

2 x 70kW Kohler (silenced) with parallel

**Fuel consumption:**

Cruising Speed 20 KTS

Max Speed 42 KTS

**Fuel Consumption (cruising)**

12 KTS - 295 L/H

20 KTS - 654 L/H

30 KTS - 930 L/H

40 KTS - 1500 L/H

**Cruising Speed:** 20 knots

**Fuel Consumption:** 654 Litres/Hr

## WATERSPORTS

**Tenders + Toys:** 1x Seadoo Spark Jetski

1x 10m (33ft) Seawake Smeralda 320 Tender

1x iAqua Seadart Pro

2x Yamaha Seawing II

1x wakeboard

1x inflatable sofa

2x paddle boards & paddles

2x inflatable dock platforms

9x Cressi fins

9x cressi face masks

3x masks + snorkel set

LAYOUT

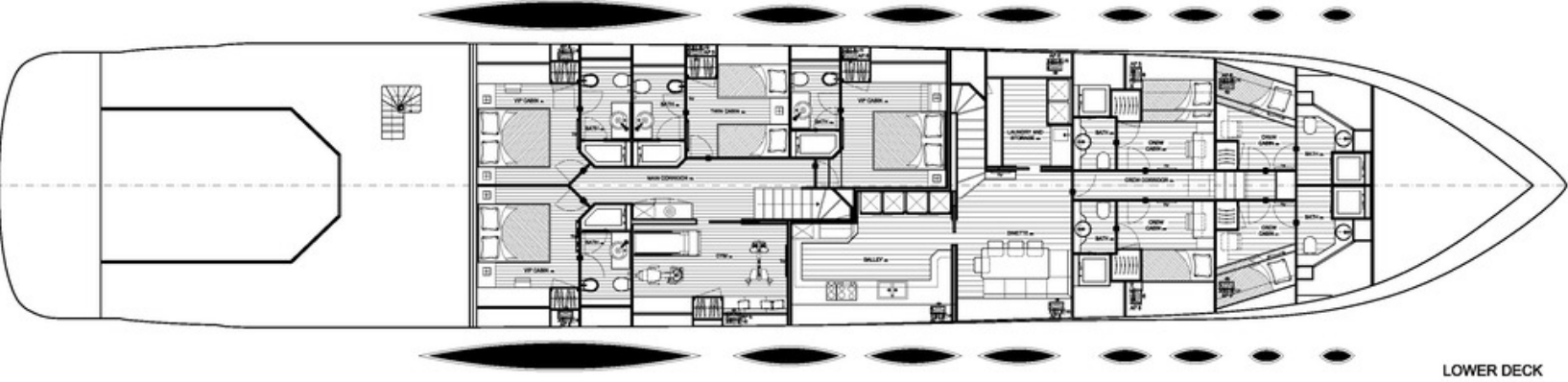
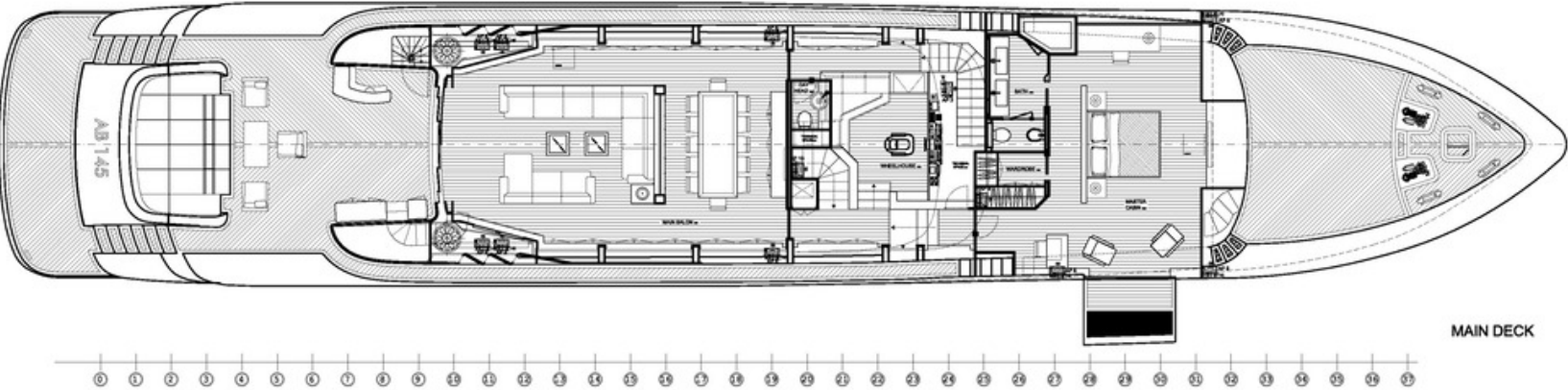
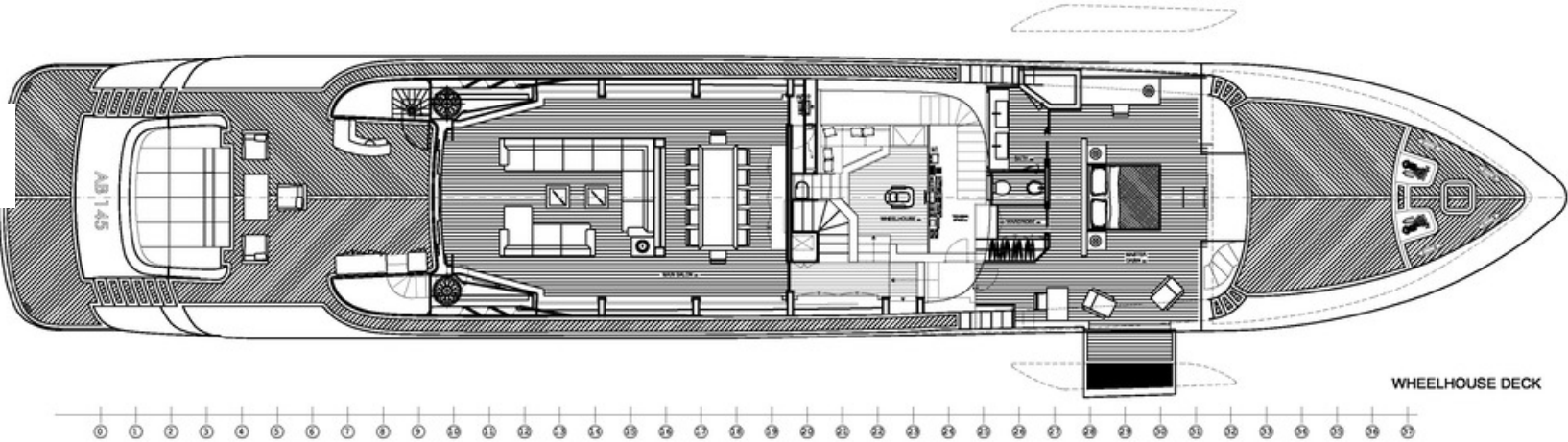



# LUXURY *Yacht* GROUP

Luxury Yacht Group LLC  
1362 SE 17th Street  
United States, Fort Lauderdale, 33316  
Tel: +19545259959  
Fax: +19545259949  
charter@luxyachts.com  
www.luxyachts.com

## **Disclaimer**

This document is not contractual. All specifications are given in good faith and offered for informational purposes only. The publisher and company do not warrant or assume any legal liability or responsibility for the accuracy, completeness, or usefulness of any information and/or images displayed. Yacht inventory, specifications and charter prices are subject to change without prior notice. None of the text and/or images used in this brochure may be reproduced without written consent from the publisher.