

LUXURY *Yacht* GROUP

AMIGOS



AMIGOS

Length: 55.00 metres (180' 5")

Beam: 9.40 metres (30' 10")

Draft: 3.4 metres (11' 1")

Number of Guests: 12

Number of Crew: 19

Built: 2017

Builder: Amels

Naval Architect: Amels

Flag: Cayman Islands

Hull Construction: Steel

Hull Configuration: Displacement

Air conditioning, Approved RYA water sports centre, Deck Jacuzzi, Gym/exercise equipment, Stabilisers at anchor, Stabilisers underway, WiFi connection on board

Delivered during the Summer of 2017, M/Y AMIGOS is an outstanding upgrade of the popular Amels 180 Limited Editions range. Her generous lines, designed by the talented and preeminent Tim Heywood, constitutes the success of this semi-custom superyacht: large volumes start from her swim platform and continue up to the Main Deck aft lounge, ideal for evening cocktails at sea. AMIGOS sets herself apart from others in her category, however, with her outstanding Bridge Deck, quite unique to her: this area is unusually placed alongside the Owner's cabin, created as such to provide a

private and exceptional 180-degree terrace fitted with circular table for 4 guests and sun loungers. Continuing up the decks, her Sun Deck is a model of her own: with a giant sunbathing on the aft, a dining table for 10 for al fresco dining, comfortably in the shade of the mast superstructure, and extra-large Jacuzzi with a contra flow pump - allowing the guests to swim on the spot - the surrounding lounge sun pad area and standalone sun loungers are unbeatable for a day relaxing in the sun. For additional entertainment, AMIGOS also boasts a projector mounted onto the back of the sunpad for an incredible home cinema experience.

Her interiors are beautified by the tasteful decoration skills of Laura Sessa, with an intelligent layout to provide the ultimate in luxury. The Main Deck salon and dining area, including a 10-person dining table, 105" curved Samsung TV, and sofas, are cleverly integrated into the design, making this space generous and warm. Views here are enhanced by fold-down balconies on both the port and starboard sides, creating your own private terrace with uninterrupted sea views. Continuing on Main Deck, discover the fully-equipped Gym, built to maintain your strength even while cruising. On the Lower Deck, the Beach Club is equipped with a steam room and a large selection of water toys, increasing further the opportunities to relax and have fun on board.

For the accommodation, AMIGOS offers 6 cabins: a generous

KEY FEATURES

- 1 Exclusive exterior layout with private Owner Deck
- 2 11.3m Intrepid 375 chase tender
- 3 Swimming pool on Sun Deck forward with Jet 'swim against' stream
- 4 Spacious beach club with Hamman
- 5 Upgraded selection of watertoys
- 6 Versatile interior layout including VIP with folding balcony
- 7 Teppanyaki/BBQ Grill on Sun Deck forward
- 8 Ample shading options throughout



Running



Aerial



Aerial



Aerial



Exterior decks



Sundeck details



Sundeck lounge



Sundeck dining



Sundeck aft



Sundeck pool



Sundeck



Sundeck cinema



Observatory deck



Owner's deck aft / Master suite



Upper deck



Upper deck / massage



Main deck aft



Main deck aft



Main salon



Main salon dining



Main salon dining



Main salon



Master bedroom



Master bedroom



Master lounge



Master ensuite



VIP suite



VIP suite with balcony



VIP ensuite bathroom



Guest cabin



Guest cabin



Guest cabin ensuite



Twin cabins entrance



Twin cabin/convertible



LILI - Twin cabin



Twin cabin ensuite

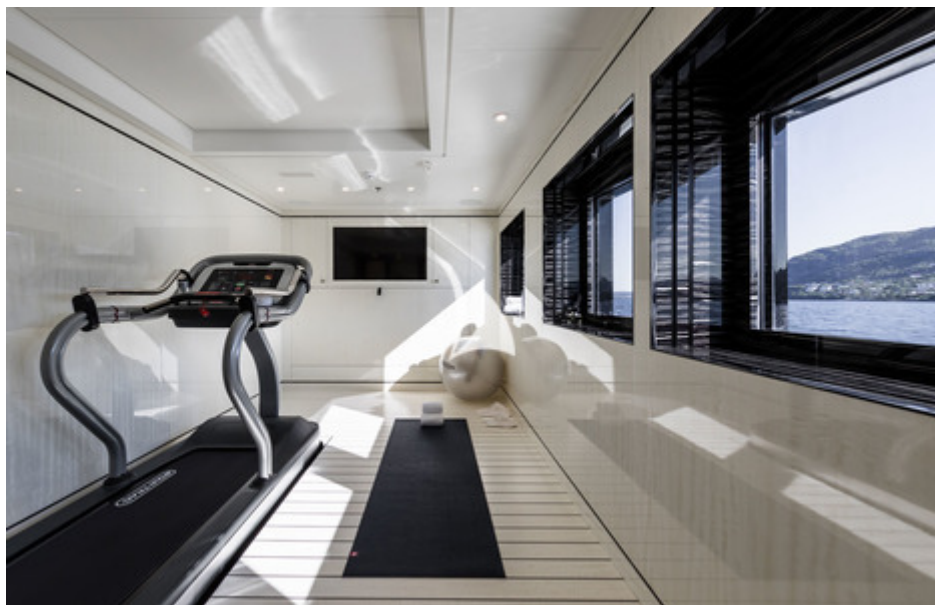

Gym



Beach club diving scenario



Beach club



Beach lunch scenario



Food



Food



Aerial



Running

SPECIFICATION

- 1 AFT DECK SUN LOUNGE
- 2 AL FRESCO DINING
- 3 FOUR METRE SWIMMING POOL
- 4 SUNBATHING
- 5 MASTER'S PRIVATE TERRACE
- 6 MASTER STATEROOM
- 7 MASTER BATHROOM
- 8 MASTER OFFICE
- 9 MASTER DRESSING
- 10 CAPTAIN CABIN
- 11 CAPTAIN OFFICE
- 12 BRIDGE
- 13 FORE DECK SUNBEDS
- 14 MAIN DECK AFT DINING
- 15 MAIN DECK SALON (DINING + CINEMA)
- 16 GALLEY
- 17 GYM
- 18 VIP STATEROOM
- 19 VIP BATHROOM
- 20 VIP DRESSING
- 21 TENDERS STORAGE + CRANE
- 22 BEACH CLUB
- 23 STEAM ROOM
- 24 DIVE STORE
- 25 2 X SINGLE GUESTS STATEROOM
- 26 2 X DOUBLE GUESTS STATEROOMS
- 27 ENGINE ROOM
- 28 CREW MESS
- 29 STORAGE
- 30 LAUNDRY
- 31 CREW ACCOMMODATION

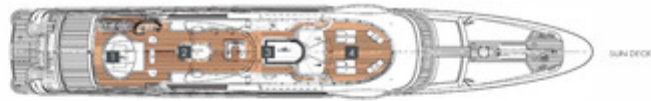

SUN DECK

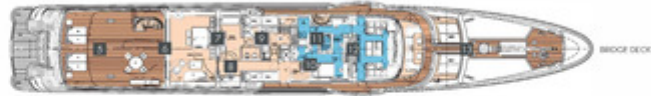

BRIDGE DECK



MAIN DECK



SCUBA DECK

SPECIFICATIONS

ACCOMMODATION

Number of Guests: 12

Number of Cabins: 6

Cabin Configuration: 4 Double, 1 Twin, 1 Convertible

Bed Configuration: 1 Pullman, 2 King, 2 Queen, 4 Single

EQUIPMENT

Engines: Main engines: 2 x MTU 2000 M70 – 1050 KW @ 2100 RPM

Generators: 2 x Northern Lights 165kW @ 100% load

Stabilizers: NAIAD Zero speed stabilizers

Delivery fees: 12knts with fuel consumption of 300ltrs per hour or 6720ltrs per day- Fuel cost may vary.

Cruising Speed: 12.5 knots

Fuel Consumption: Cruising speed 300 / Max speed 480 Litres/Hr

WATERSPORTS

Tenders + Toys: 1 x 11.3m Intrepid 375 chase tender

1 x Ribeye 6.19m Rescue Tender/Water Sports Tender, Mercury 150HP Outboard

2 x Seadoo 230hp, GTR 230 Jet Ski

3 x SeaBob 5.36hp F5S

6 x Dive Rite Scuba Diving sets (range of sizes)

2 x Jobe Vanity Wakeboards - 1 adult and 1 youth

2 x Inflatable Stand-up Paddleboards – Jobe 10.6 foot

2 x Jobe Hemi Water Skis (adult)

2 x Inflatable Tender-towables (2 seats ant tube)

1 x Aquaglide Jungle Jim

1 x Aquaglide Rebound 12

1 x Jobe Large disc 3 pax

Floating pontoons with pool/jelly fish net

Various Fishing Gear

All particulars are given in good faith and are believed to be correct but cannot be guaranteed. Please do not hesitate to contact the central agent to confirm any of the toys on board.

LAYOUT

CONFIGURATION

- 1 FT DECK SUN LOUNGE
- 2 FRESKO DINNING
- 3 FOUR-METRE SWIMMING-POOL
- 4 SUNBATHING
- 5 MASTER'S PRIVATE TERRACE
- 6 MASTER STATEROOM
- 7 MASTER BATHROOM
- 8 MASTER OFFICE
- 9 MASTER DRESSING
- 10 CAPTAIN CABIN
- 11 CAPTAIN OFFICE
- 12 BRIDGE
- 13 FORE DECK SUNBEDS
- 14 MAIN DECK AFT DINNING
- 15 MAIN DECK SALON (DINNING + CINEMA)
- 16 GALLEY
- 17 GYM
- 18 VIP STATEROOM
- 19 VIP BATHROOM
- 20 VIP DRESSING
- 21 TENDERS STORAGE + CRANE
- 22 BEACH CLUB
- 23 STEAM ROOM
- 24 DIVE STORE
- 25 2 X SINGLE GUESTS STATEROOM
- 26 2 X DOUBLE GUESTS STATEROOMS
- 27 ENGINE ROOM
- 28 CREW MESS
- 29 STORAGE
- 30 LAUNDRY
- 31 CREW ACCOMODATION

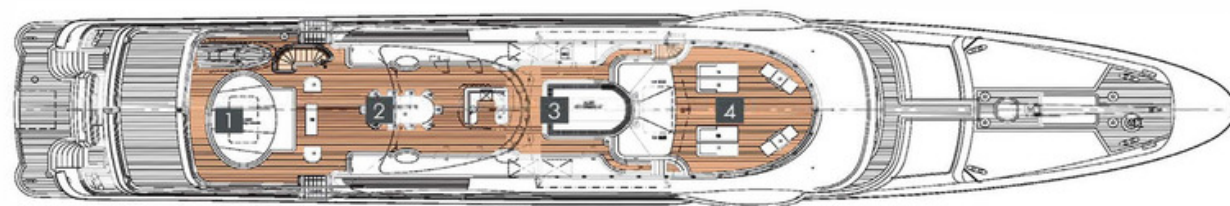

SUN DECK

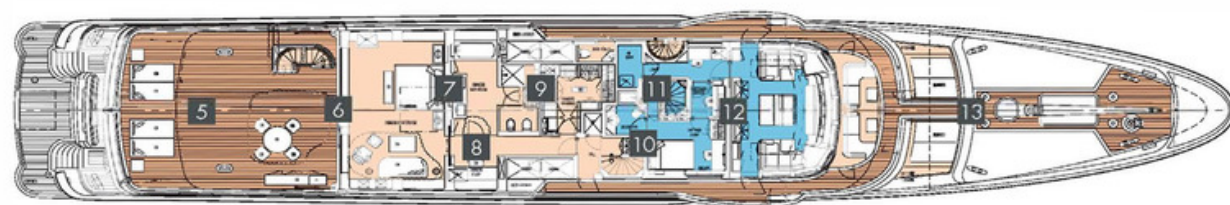

BRIDGE DECK

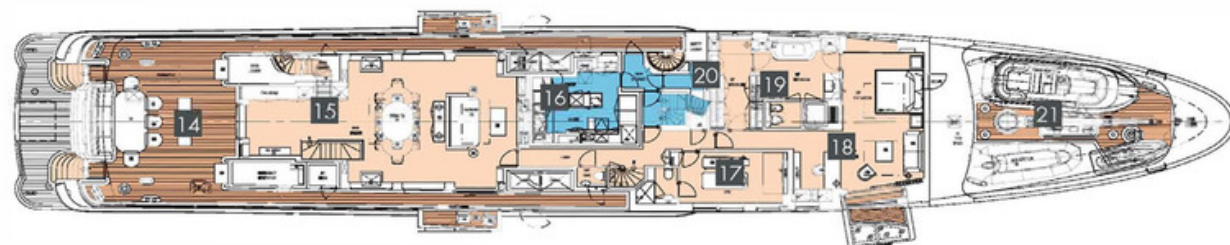

MAIN DECK

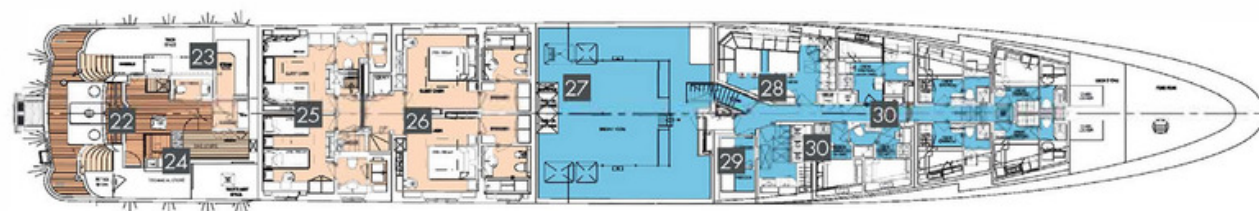

LOWE DECK

LUXURY *Yacht* GROUP

Luxury Yacht Group LLC
1362 SE 17th Street
United States, Fort Lauderdale, 33316
Tel: +19545259959
Fax: +19545259949
charter@luxyachts.com
www.luxyachts.com

Disclaimer

This document is not contractual. All specifications are given in good faith and offered for informational purposes only. The publisher and company do not warrant or assume any legal liability or responsibility for the accuracy, completeness, or usefulness of any information and/or images displayed. Yacht inventory, specifications and charter prices are subject to change without prior notice. None of the text and/or images used in this brochure may be reproduced without written consent from the publisher.